

SUBMITTED MODEL NO.
FCS-100-VRM1214-MCRP-1.25
CHROME FINISH

JOB NAME	ITEM	Retrofits Existing Receiver Plate with 1/2-14 NPT Female Threads
SUBMITTED AS SHOWN		
SUBMITTED AS NOTED		

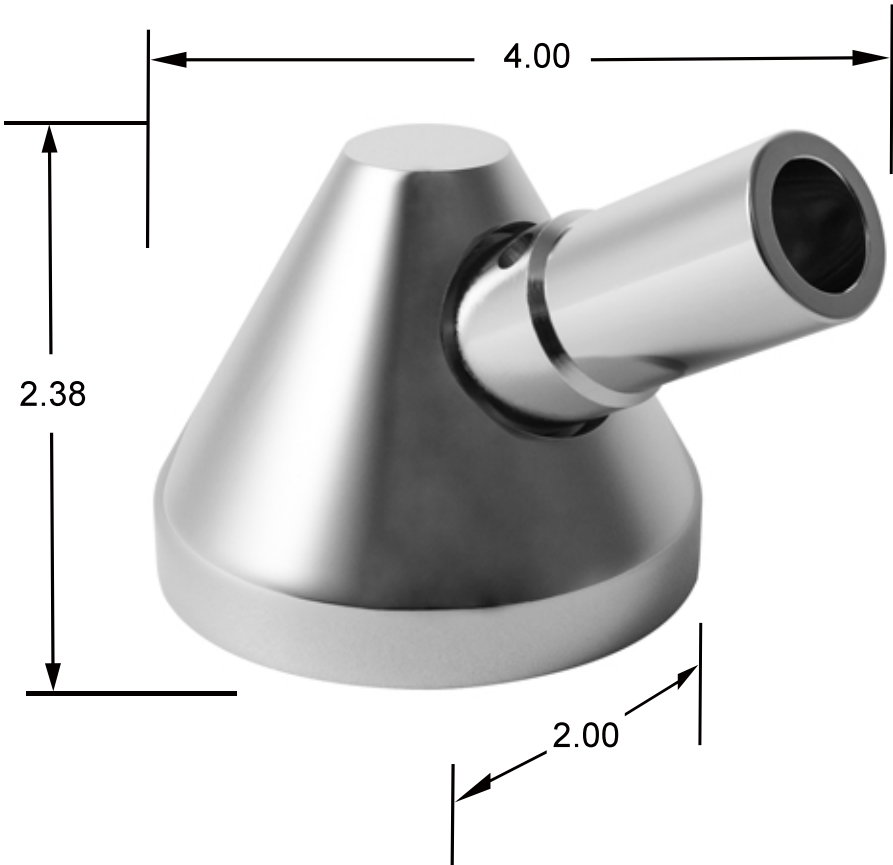

\*DIMENSIONS IN INCHES

SPECIFICATIONS	NOTES
<div> <div>①</div> FCS™ Patented Stainless Steel Single Non-Clogging Nozzle. </div> <div> <div>②</div> Non-Clogging Silicone Flow Control Diaphragm 1.25 GPM at 30-80 psi. Pressure Compensating. </div> <div> <div>③</div> Inlet Threads: 1/2"-14 NPT Female. </div> <div> <div>④</div> All Metal Construction; Brass and Stainless Steel. Fully Drains After Each Use. Naturally Antibacterial. Chrome Plated. Wt: 1.3 lbs. </div> <div> <div>⑤</div> Receiver Plate with High Sierra® Shower Head. </div> <div> <div>⑥</div> Vandal and Ligature Resistant. </div> <div> <div>⑦</div> Certifications: A112.18.1, and WaterSense. California Compliant. </div> <div> <div>⑧</div> Compliant with Buy American Act (BAA). U.S. Patent 7,185,830 B2 and Patent Pending. </div>	<div> <div>Spanner Wrench with 3/16" pin for shower head removal.</div> </div>